

## BLOCK-IT<sup>®</sup> Floor Underlayment Installation Instructions

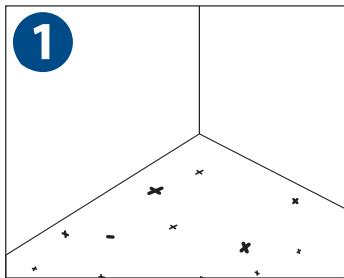

### STEP 1

Sweep clean and remove all debris from sub floor.

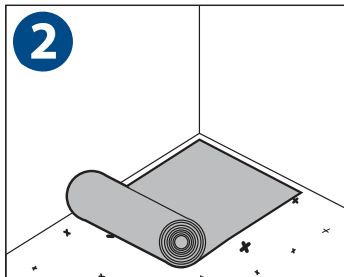

### STEP 2

Run the first sheet of Kimberly-Clark BLOCK-IT<sup>®</sup> Floor Underlayment along the longest wall in the room positioning the gray textured side facing up. If desired, place only enough staples along the wall to keep underlayment flat.

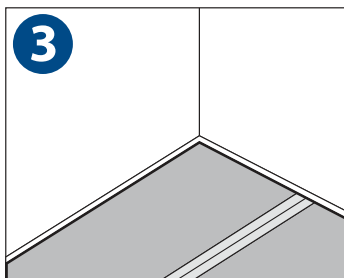

### STEP 3

Lay out each additional row of Kimberly-Clark BLOCK-IT<sup>®</sup> Floor Underlayment with the additional row edge underneath the previous row seams. If desired, use tape along the row seams.

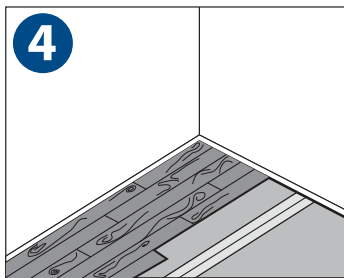

### STEP 4

Lay flooring directly over the top of Kimberly-Clark BLOCK-IT<sup>®</sup> Floor Underlayment according to flooring manufacturer installation instructions.